

FRIALEN USTRS RACCORD DE TRANSITION PE LISSE À SOUDER / ACIER À SOUDER

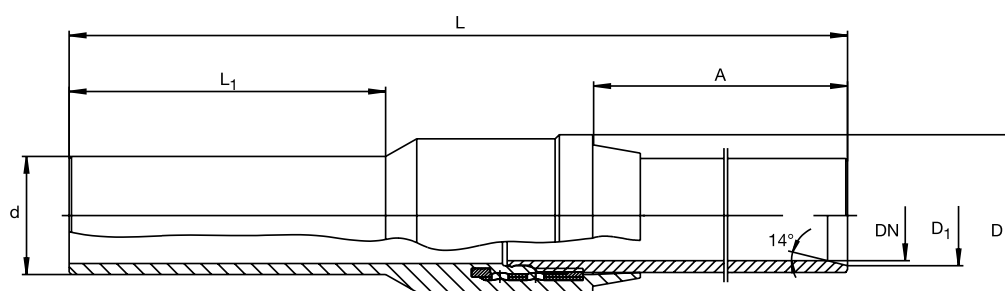

PE 100 SDR 11 (eau 16 bar, gaz 10 bar).



d/DN	Code	D	L	t	h	B	Poids
mm		mm	mm	mm	mm	mm	kg
32/25	T-615 475	48,5	28,0	465	100	300	1,185
40/32	T-615 476	57,5	36,5	500	133	300	1,604
50/40	T-615 477	68,5	42,5	520	133	300	2,400
63/50	T-615 478	82,5	54,5	540	153	300	2,684

INSTRUCTIONS DE MONTAGE DISPONIBLES SUR NOTRE SITE

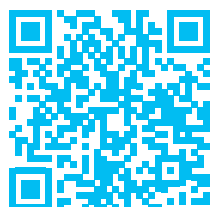

d < 250 mm

www.aliaxis.fr

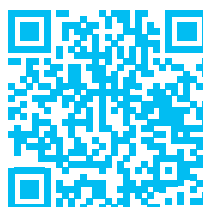

d > 250 mm

